

"DSV" SILO STORAGE TANKS



MUELLER[®]

THE MILK COOLING SYSTEMS SPECIALISTS[™]

MUELLER® "DSV" SILO STORAGE TANKS

Mueller® Silos — The Ultimate in Product Protection!

Mueller® "DSV" silos provide the ultimate in product protection during storage and their vertical design allows maximum product storage in a minimum of space. Mueller is the only silo manufacturer to go to the time and expense to



offer a stud-welded, circumferentially banded bottom construction which protects against fatigue. Mueller offers "DSV" silos in 7,000, 8,000, 10,000, 12,000, 15,000, 20,000, and 30,000 gallon sizes for your convenience.

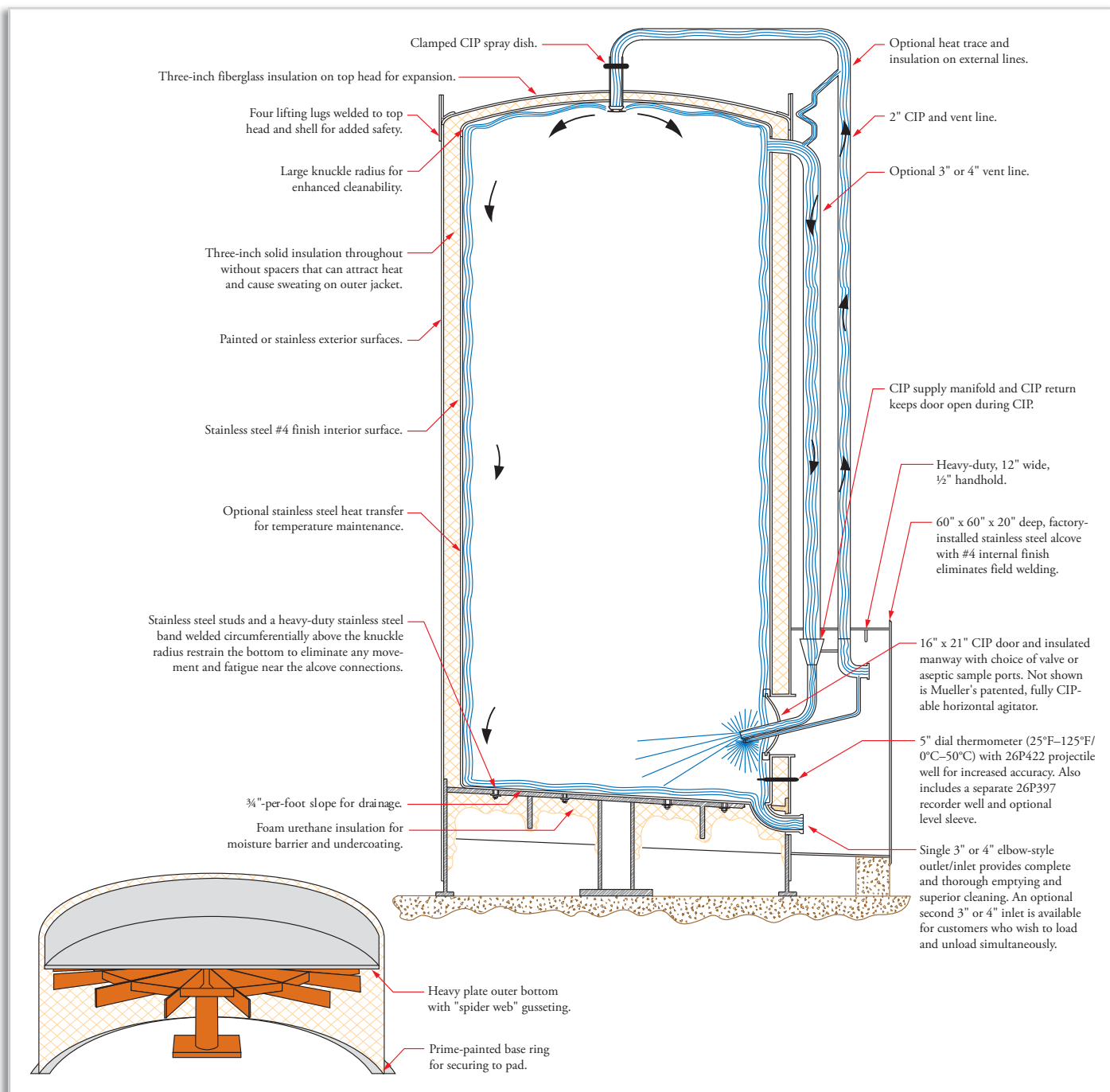

“DSV” Silo Features

Standard Features

- Cylindrical, vertical style with 120" inside diameter (140" inside diameter on 30,000-gallon silo).
- Inside lining is Type 304 stainless steel, No. 4 finish.
- 3" rigid insulation.
- Outer jacket made of carbon steel, prime painted.
- 3" inlet/outlet ferrule only – outlet valve optional.
- 12 gauge, stainless steel alcove, 60" x 60" ID, 62¹/₂" x 62¹/₂" (± 1/4") x 20" deep. No. 4 finish on inside.
- Stainless steel manway, 15¹/₂" x 20¹/₂", insulated, inside closing, optional sampling device may be added if desired.
- Removable CIP spray dish that requires 90 gpm at 6 psig (optional CIP attachment and CIP door must be added).
- Perforated and removable vent screens.
- Mechanical, horizontal agitation with hollow-shaft gear motor.
- Dial-type thermometer, 20°F to 120°F.
- Thermometer well for recording thermometer.

Optional Features

- 3" disc-type outlet valve with gasket and clamp.
- CIP attachment (required for CIP to wash agitator and fail-safe device with manway door interlock). For multiple silo installations only one is required.
- CIP door (required for CIP wash). Only one is required for multiple silo installations.
- Stainless steel inflated-type Mueller Temp-Plate® heat transfer surface for chilled water.
- External liquid level gauge (requires field calibration).
- Sample cock, manual sampling valve in manway door.
- Aseptic sample (required for aseptic style sampling).
- QMI fitment door (optional for aseptic sampling QMI fitment).
- Customer specified liquid level shell for field installation of custom liquid level device.
- Additional connections or stubs, 3" or 4" in size.
- Exterior white Wilkothane paint.
- Stainless steel outer jacket.
- Heat tape for CIP and vent lines. (Required in cold weather climates.)

“DSV” Silo Specifications

Capacity U.S. Gallons/Liters	Dimensions (in)			Agitator		Empty Weight (lbs)
	A	B	C	HP	RPM	
5,000 / 18,925	98	104 ¹ / ₂	199 ⁷ / ₈	1	107	7,600
6,000 / 22,710	98	104 ¹ / ₂	230 ⁵ / ₈	1	107	8,200
7,000 / 26,495	120	126 ¹ / ₂	192 ¹ / ₄	1	107	9,000
8,000 / 30,280	120	126 ¹ / ₂	212 ¹ / ₄	1	107	9,600
10,000 / 37,850	120	126 ¹ / ₂	254 ¹ / ₈	2	108	10,700
15,000 / 56,775	120	126 ¹ / ₂	356 ⁵ / ₈	2	108	13,300
20,000 / 75,700	120	126 ¹ / ₂	459 ¹ / ₄	3	161	17,500
25,000 / 94,625	140	146 ¹ / ₂	424 ¹ / ₂	3	161	18,900
30,000 / 113,550	140	146 ¹ / ₂	502 ³ / ₄	3	161	22,000

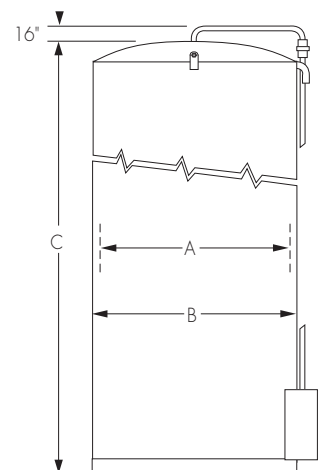

MUELLER[®]

P.O. Box 828 • Springfield, Missouri 65801-0828, U.S.A.

DFE Internal Sales: 1-888-645-5826 • Phone: (417) 575-9000 • 1-800-MUELLER

Fax: (800) 436-2466 • www.muel.com • E-mail: dairyfarm@muel.com